

L0111A-PAS102 SYSTEM DATASHEET

SYSTEM PERFORMANCE	METRIC	IMPERIAL
Sine Force Peak kN (lbf)	0.98	220
Random Force rms kN (lbf)	0.98	220
Shock Force (6ms) kN (lbf)	1.96	440
Useful Frequency Range Hz	5 - 4500	5 - 4500
Continuous Displacement mm (in)	25	1.0
Shock Displacement mm (in)	25	1.0
Max Velocity m/s (in/s)	2	78.7
Max Acceleration Sine Peak m/s ² (g)	490	50

Air-cooled system ideally suited to test small sized electronic parts, connectors, hand-held units and small mechanical assemblies.

- Continuous displacement 25 mm (1.0 in)
- Useable frequency range 5 - 4500 Hz
- Max static payload 70 kg (154 lb)
- Air-cooled amplifier efficiency > 90%
- Rugged isolated trunnion

L0111A SHAKER	METRIC	IMPERIAL
Armature Diameter mm (in)	110	4.3
Armature Material	Al	Al
Effective Armature Mass kg (lb)	2	4.4
Armature Insert Pattern PCD mm (in) plus 1 in center	6-90	6-3.5
Armature Insert Threads	M8	5/16-18UNC
First Resonant Frequency (bare table) ±5% Hz	3350	3350
Max Static Payload kg (lb)	70	154
Natural Frequency Thrust Axis Hz	< 5	< 5
Stray Flux Density gauss	< 10	< 10
Shaker Weight Uncrated kg (lb)	410	904
Dimensions Uncrated (W x D x H) mm (in)	660 x 541 x 625	26.0 x 21.3 x 24.6

PAS102 POWER AMPLIFIER	METRIC	IMPERIAL
Number of Sub-modules Supplied	1	1
Rated Power Output kVA	2	2
Rated Output Voltage V rms	90	90
Rated Output Current A rms	13	13
Number of Cabinets	1	1
System Required Power kVA	4.5	4.5
Amplifier Weight Uncrated kg (lb)	230	507
Dimensions Uncrated (W x D x H) mm (in)	580 x 850 x 1040	22.8 x 33.5 x 40.9

BU-1 BLOWER	METRIC	IMPERIAL
Standard Air Hose Length m (ft)	3	9.8
Hose Diameter mm (in)	123	4.8
Blower Unit Weight Uncrated kg (lb)	26	57.3
Dimensions (W x D x H) mm (in)	430 x 450 x 370	16.9 x 17.7 x 14.6

SLIP TABLES

Mono-base slip tables in a wide-range of sizes and configurations for maximum over-turning moment and cross-axial restraint

OPTIONS & ACCESSORIES

Sentek Dynamics offers a wide selection of options and accessories for unique applications and complete turn-key systems.

- Custom armature and slip table insert patterns and threads available
- Air-isolation feet, pads and mounts to eliminate need for seismic floor
- Thermal barrier for use with environmental test chambers
- Remote control panel for remote operation



SHAKER MODEL L0111A

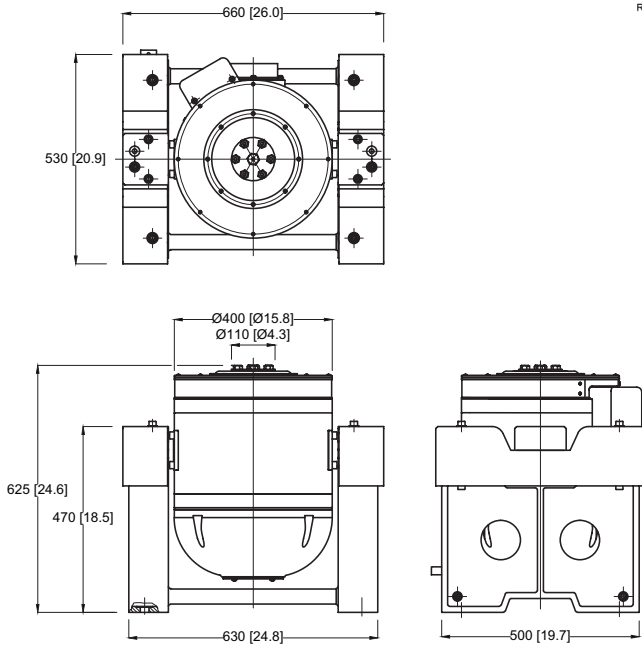

POWER AMPLIFIER MODEL PAS102

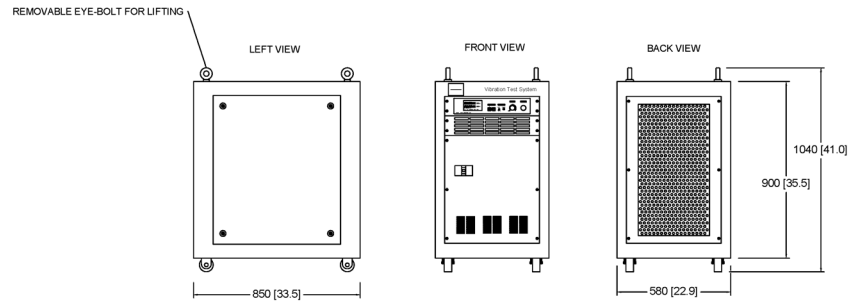

BLOWER UNIT MODEL BU-1

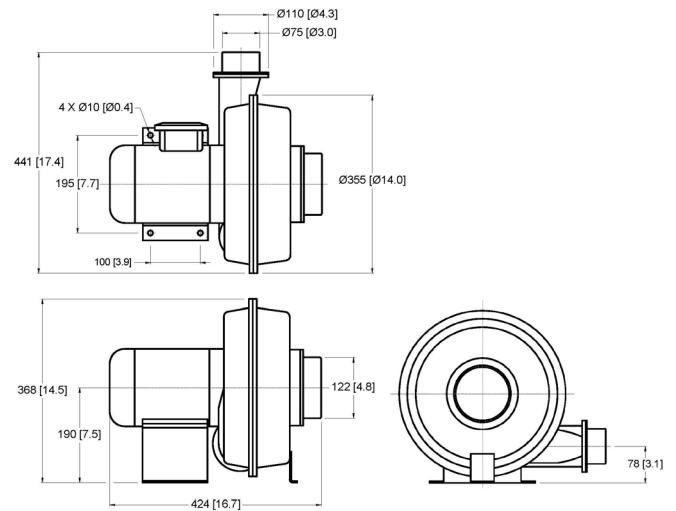

ARMATURE INSERT PATTERN

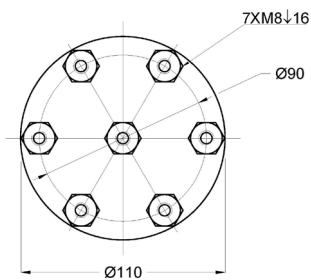

SENTEK DYNAMICS
2370 OWEN STREET
SANTA CLARA, CA 95054
UNITED STATES OF AMERICA

PHONE: +1.408.200.3100 | FAX: +1.408.659.8229 | WWW.SENTEKDYNAMICS.COM | SALES@SENTEKDYNAMICS.COM

© 2017 Sentek Dynamics, All Rights Reserved. 03/2017

Notice: This document is for informational purposes only and does not set forth any warranty, expressed or implied, concerning any equipment, equipment feature, or service offered or to be offered by Sentek Dynamics. Sentek Dynamics reserves the right to make changes to this document at any time, without notice, and assumes no responsibility for its use. This informational document describes features that may not be currently available. Contact a Sentek Dynamics sales representative for information on features and product availability.